

Exploded view
SCS | SCS-D | CB-SCS

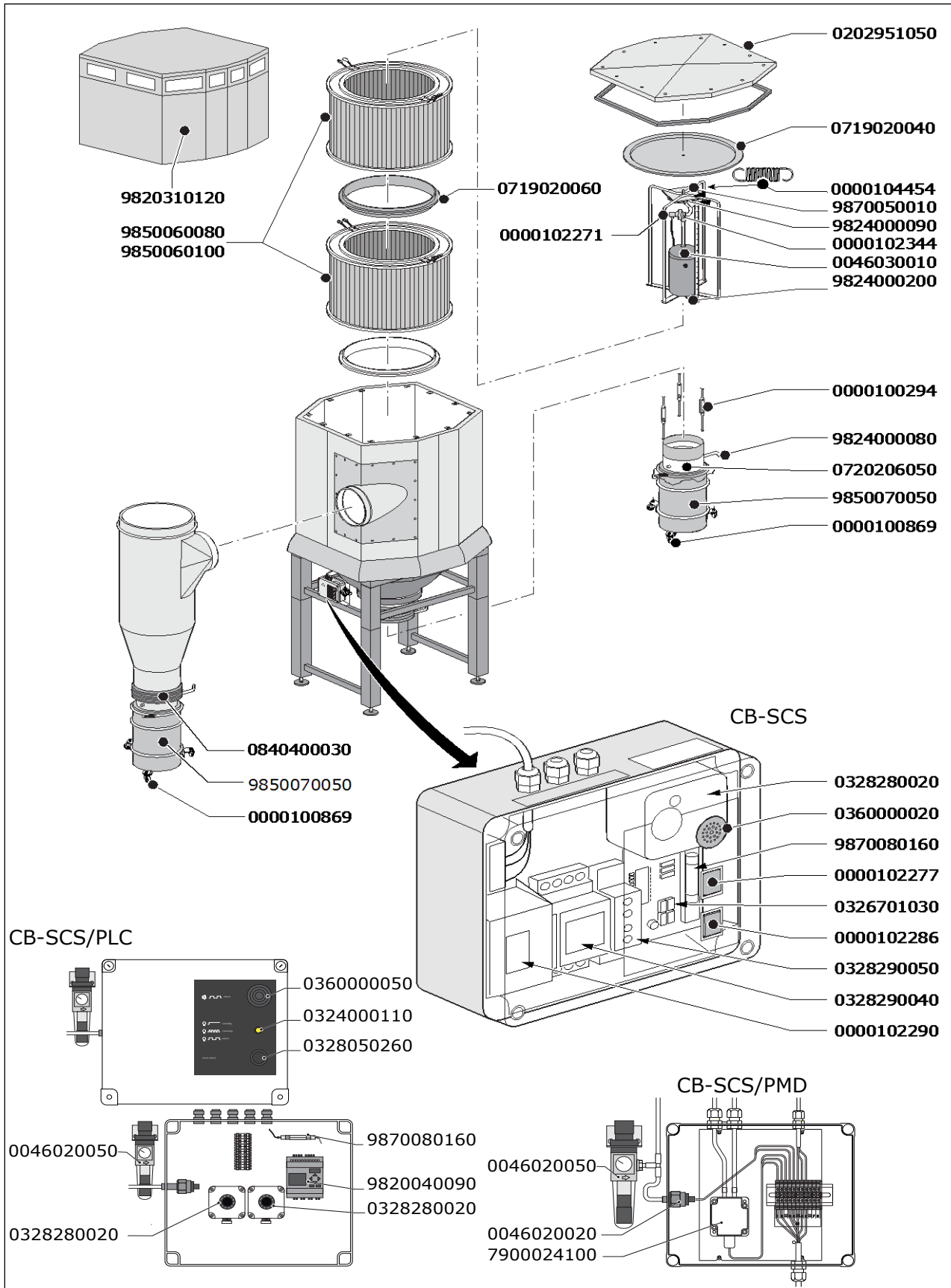

Spare parts SCS | SCS-D

Art. no.	Description	0
• SCS SCS-D		
0000100294	Distance holder	-
0000100869	DB-TROLLEY / Trolley for dustbin DB-90 and DB-100	-
0000102271	Magnetic valve	-
0000102344	Membrane + spring of magnetic valve	-
0000104454	Tension spring	-
0046030010	Safety valve 6-10 bar for compressed air tank	-
0202951050	Lid housing SCS	-
0719020040	Filter cover plate SCS	-
0719020060	Intermediate ring SCS	-
0720206050	Flange for dustbin DB-100	-
0840400030	Bush for dustbin DB-100	-
9824000080	Closing valve for dustbin DB-100	-
9824000090	Piston mechanism MFS/SFS/SCS	-
9824000200	Revision set bottom cleaning mechanism SCS	-
9850060080	Filter FCC-150 (2-piece)	-
9850060090	Filter residu bag FRB 100 (10 pieces)	-
9850060100	Filter FCP-110 (2-piece)	-
9850070050	DB-100 / Dustbin 100 litres incl. lid and handles	-
9870050010	Modification kit cleaning mechanism SCS (top)	-
• SCS-D		
9820310120	Air inlet module EDS*LDS	-

CB-SCS | CB-SCS/PLC | CB-SCS/PMD | CB-EDS

Art. no.	Description	0
• CB-SCS		
0000102277	Control lamp 28V, yellow	-
0000102286	Reset/start button	-
0000102290	Transformer 50W/24V 115/230/400V	-
0326701030	PC board control SCS	-
0328280020	Pressure difference switch 6-50 mBar	-
0328290040	Digital week timer SCS	-
0328290050	Relay pulse/pause SCS	-
0360000020	Buzzer MFS-BIA/SCS	-
• CB-SCS/PLC		
0046020020	Pressure switch	-
0046020050	Pressure reducing valve with oil/water separator	-
0324000110	Status LED yellow CB-SCS/PLC	-
0328050260	Reset alarm button CB-SCS/PLC	-
0328280020	Pressure difference switch 6-50 mBar	-
0360000050	Buzzer CB-SCS/PLC	-
7900023000	PLC service set	-
9820040090	PLC CB-SCS/PLC; incl. varistor + software	-
9870080160	Fuse 2 A (10 pieces)	-
• CB-SCS/PMD		
0046020020	Pressure switch	-
0046020050	Pressure reducing valve with oil/water separator	-
7900024100	Pressure transmitter PT-2500	-
• CB-EDS		
9820040100	PLC EDS; incl. varistor + software	-