

Exploded view  
**SFE-25 | SFE-50 | HFE-25 | HFE-50**

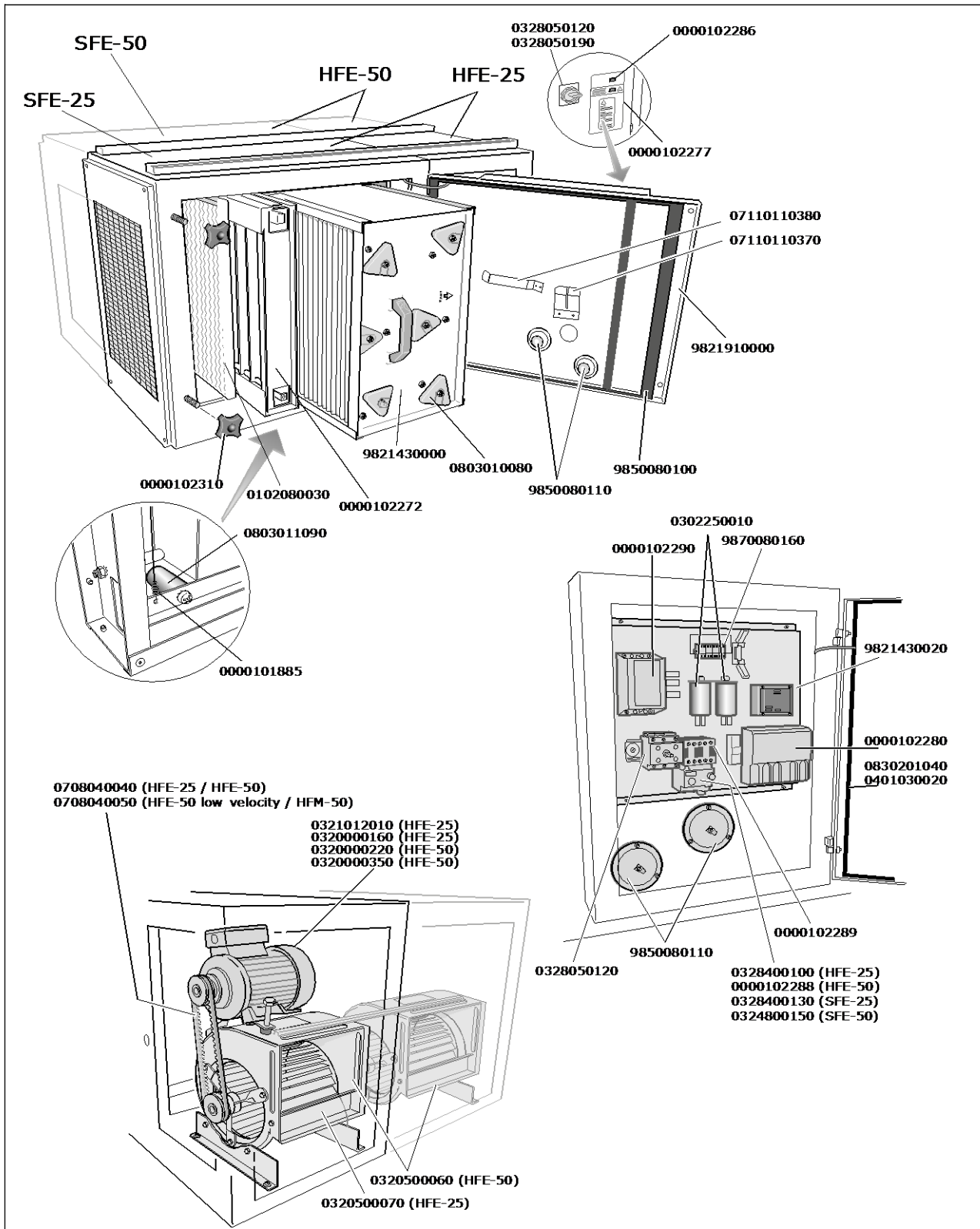

Spare parts

**SFE-25 | SFE-50 | HFE-25 | HFE-50**

Art. no.	Description	0
0000101885	Ionisation wire for FIS (10 pcs)	-
0000102272	Ioniser FIS	-
0000102273	Aluminium pre/final filter SAF	-
0000102277	Control lamp 28V, yellow	-
0000102280	PC board HT MFE/SFE	-
0000102288	Thermal relay NTR-3.0-4.7A	-
0000102289	Relay MC2A	-
0000102290	Transformer 50W/24V 115/230/400V	-
0000102310	Star knob M8	-
0103003010	Final filter SSF (G3)	-
0104060010	Activated carbon final filter SCF	-
0302250010	Capacitor 0,5 µF/660V	-
0320000160	Motor 0.75 kW, 400V/3ph/50Hz	-
0320000220	Motor 1.5 kW, 230V/1ph	-
0320000350	Motor 1,5 kW, 230-400V/3ph/50Hz	-
0320500060	Fan 200x180 double	-
0320500070	Fan 200x180 single	-
0321012010	Motor 0.75 kW, 230V/1ph.	-
0328400100	Thermal relay NTR-1.4-2.0A	-
0328400130	Thermal relay NTR-4.0-6.3A	-
0328400150	Thermal relay NTR-7.5-10.5A	-
0708040040	V-belt SPZX 760	-
0708040050	V-belt SPZX 817	-
0711011370	Earth contact	-
0711011380	Discharge spring	-
0803010080	Insulator FCS	#N/B
0803011090	Insulator FIS	-
9821430000	Collector FCS	-
9821430020	High tension transformer SFE/HFE	-
9821910000	Door SFE complete	-
9850080110	Insulators SFE/HFE (set of 2 pieces)	-
9870080160	Fuse 2 A (10 pieces)	-
<b>• SFE/HFE models before November 2004:</b>		
0328050120	Main switch VCO	-
0830201040	Sealing door electropart	-
9850080100	Sealing door SFE/HFE	-
<b>• SFE/HFE models after November 2004 (serial no. &gt;S5010460002):</b>		
0000102286	Reset/start button	-
0328050190	Main switch SFE/HFE/MSA	-

**SFM-25 | SFM-50**

Art. no.	Description	0
0000102273	Aluminium pre/final filter SAF	-
0000102310	Star knob M8	-
9850080050	Bag filter SBF	-
9850080130	Sealing door SFM-25/50	-