

Internal Grabber

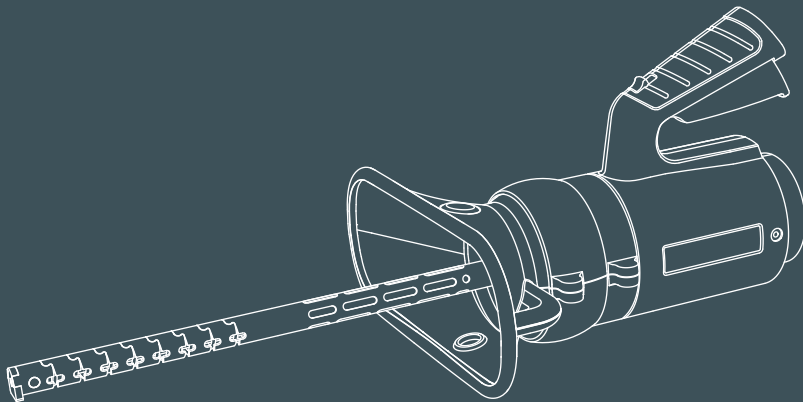

QUICK START GUIDE

PLYMOVENT®

www.plymovent.com

① Remove pull rod

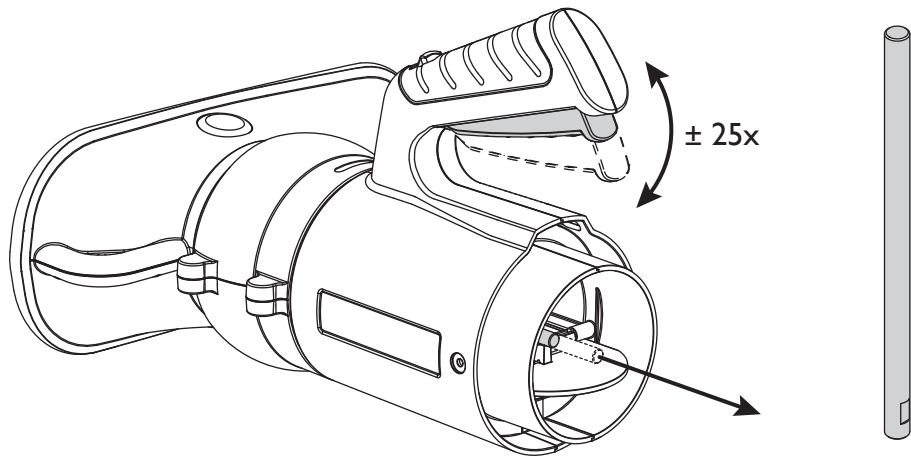

Continuously operate the handle until the pull rod can be removed from the rear.

② Assemble pull rod

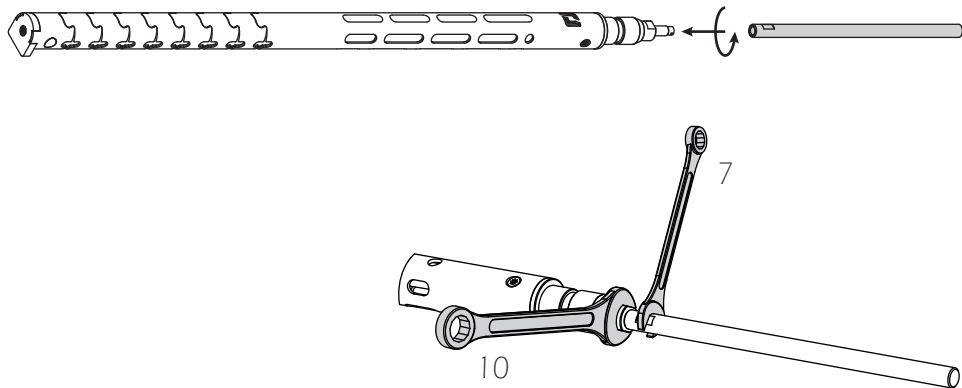

Thread the pull rod onto the snout and lock it in place.

3

Insert snout

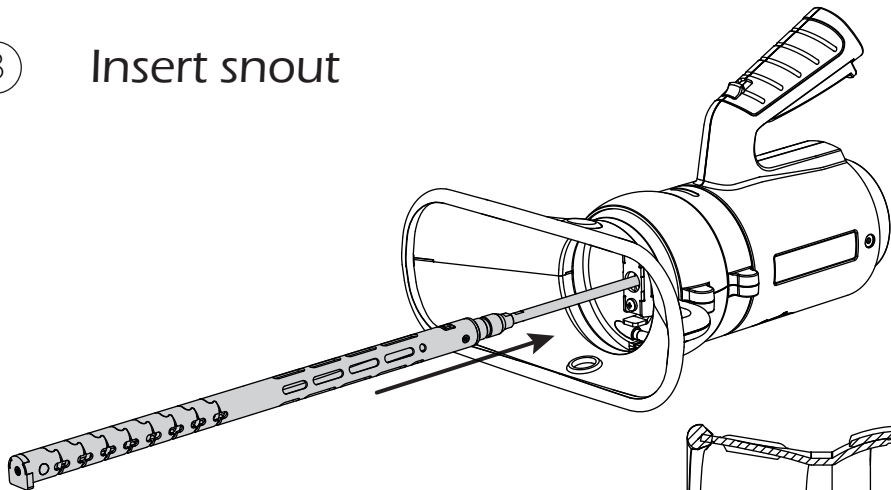

Insert the snout into the grabber up to the stop. Press the button to ease the assembly.

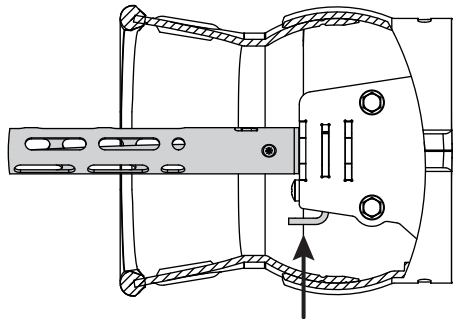

4.1

Connect hose (100 mm / 4")

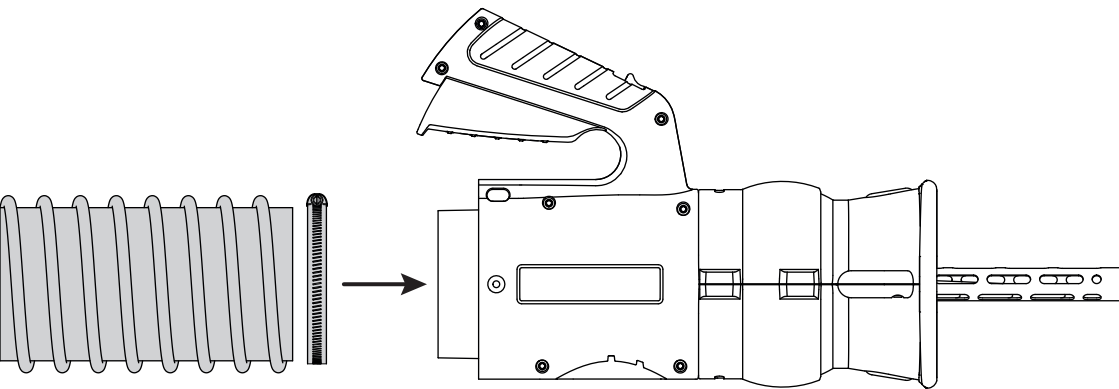

In case of a 100 mm / 4" hose, connect directly onto the grabber.

4.2

Connect hose (75-125-150 mm / 3"-5"-6")

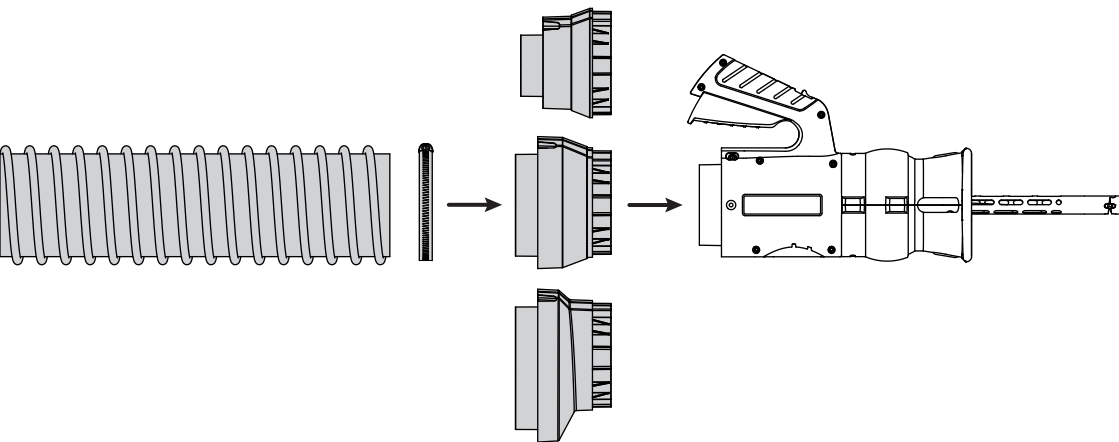

In case of a 75 mm / 3" hose, connect via the reducer.

In case of a 125 mm / 5" or 150 mm / 6" hose, connect via an increaser.



Quick tip - Soft release

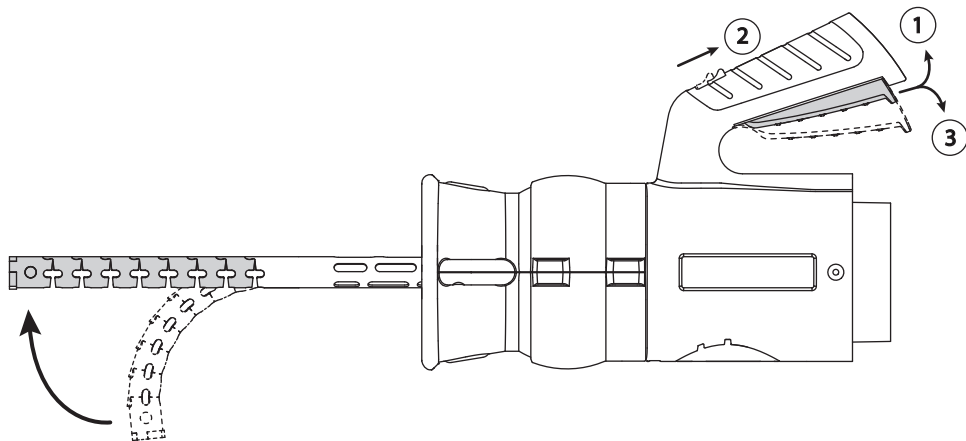

Lightly pinch the handle before releasing the snout.



Quick tip - Pivot & slide

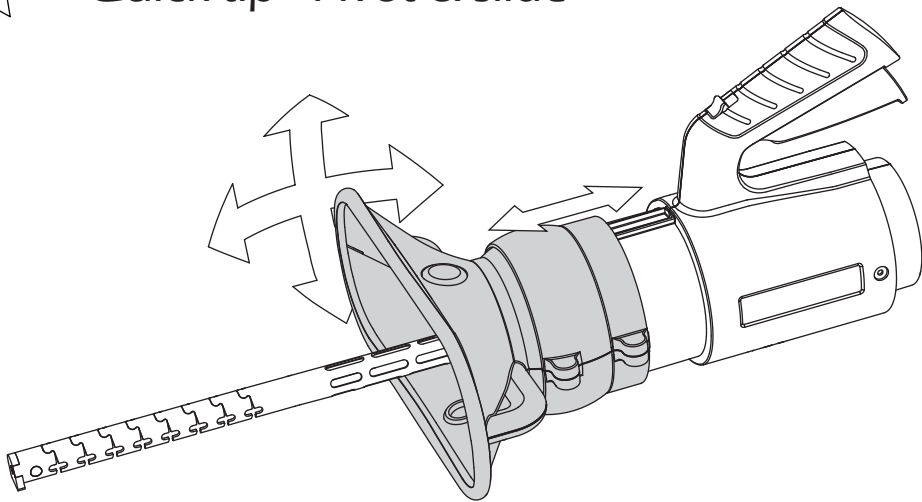

Adjust the front of the grabber to better capture exhaust fumes.



Quick tip - Wall mount

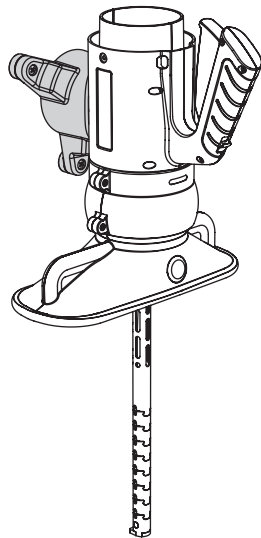
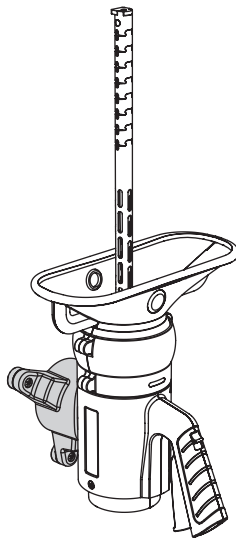

The grabber can be orientated facing up or down.

